

The Bathory 200

QBSA: 1039722



www.johnprovanbuilding.com.au



Living Area: 125.2 m²
 Porch Area: 3.5 m²
 Pergola Area: 25 m²
 Laundry/Garage: 45.6 m²
Total Area: 199 m²

This 3 bedroom/double garage design has a main bedroom and ensuite separate from the living areas ensuring privacy for a young family.

Or equally the separate areas also make it an ideal rental/investment home.

It is economical to build and easily adjusted for a corner block. On standard blocks access to the back yard is gained through the large double garage.

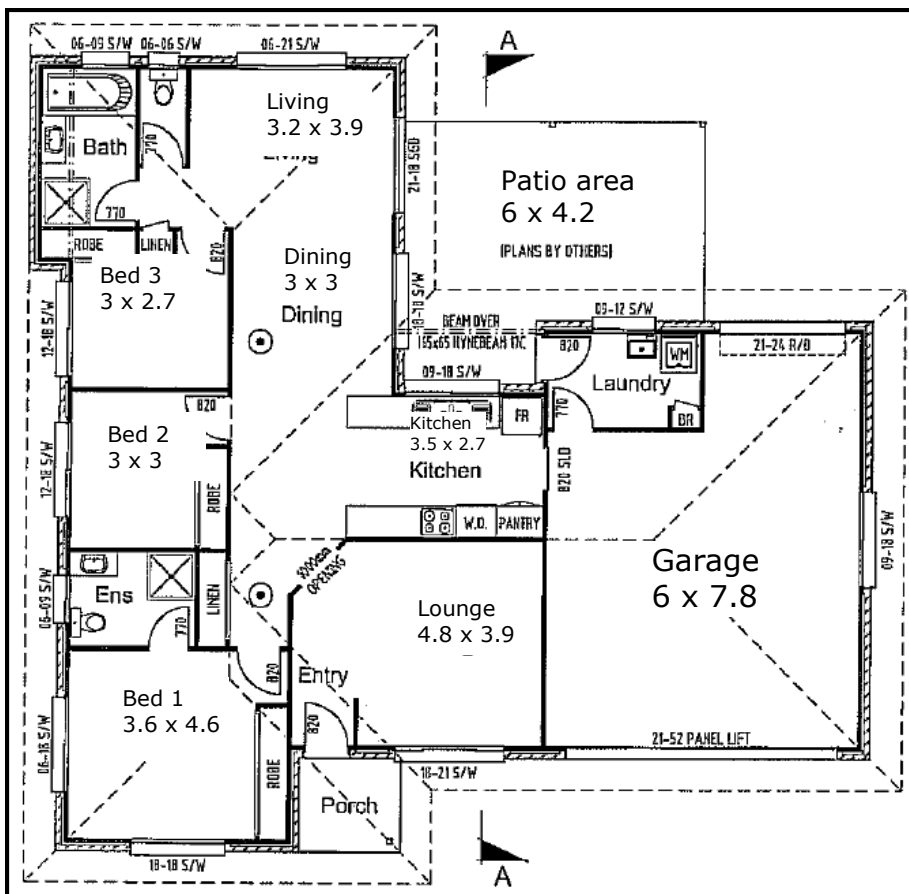

133 YOUNGMAN STREET, KINGAROY QLD 4610
 PHONE 07 4162 5922 FAX 07 4162 5933
 EMAIL admininfo@johnprovanbuilding.com.au